



THE RESORT

JEBEL ALI BEACH  
DUBAI

FACTSHEET



An aerial photograph of JA The Resort, a large luxury hotel complex. The resort features a central white hotel building with a curved facade, surrounded by lush green lawns, palm trees, and swimming pools. To the left, there is a marina with numerous yachts docked. The resort is situated on a peninsula, with a sandy beach and the sea to the right. In the background, a golf course and other resort buildings are visible.

# ONE MILLION SQUARE METRES OF UNIQUE MEMORABLE EXPERIENCES

**JA The Resort is home to  
three iconic hotels:**

JA Beach Hotel, JA Palm Tree Court  
and JA Lake View Hotel.

The resort comprises an area of 1 million  
square metres and has 25 restaurants  
and over 40 experiences.





STAY



## JA PALM TREE COURT

TRULY SERENE BEACHFRONT VILLA SUITES

212 suites

- **88 Garden View Junior Suites - 60m<sup>2</sup>**  
Accommodates up to 2 adults, 2 children & 1 infant
- **36 Sea View Junior Suites - 60m<sup>2</sup>**  
Accommodates up to 2 adults, 2 children & 1 infant
- **22 Garden Terrace Suites - 62m<sup>2</sup>**  
Accommodates up to 2 adults, 2 children & 1 infant
- **22 Premium Garden Terrace Junior Suites - 62m<sup>2</sup>**  
Accommodates up to 2 adults, 2 children & 1 infant
- **24 Beachfront Terrace Junior Suites - 62m<sup>2</sup>**  
Accommodates up to 2 adults, 2 children & 1 infant
- **8 Sea View Residence Junior Suites - 60m<sup>2</sup>**  
Accommodates up to 2 adults, 2 children & 1 infant  
Enhanced residence benefits
- **6 Sea View One Bedroom Suites - 120m<sup>2</sup>**  
Accommodates up to 2 adults, 3 children & 1 infant  
Enhanced residence benefits
- **4 Beachfront Residence One Bedroom Suites - 124m<sup>2</sup>**  
Accommodates up to 2 adults, 3 children & 1 infant  
Enhanced residence benefits
- **2 Sea View Residence Two Bedroom Suites - 210m<sup>2</sup>**  
Accommodates up to 4 adults, 3 children & 1 infant  
Enhanced residence benefits





STAY



## JA BEACH HOTEL

DUBAI'S FIRST RESORT

### 235 rooms & suites

- **169 Resort View and Sea View Rooms - 32m<sup>2</sup>**  
Accommodates up to 2 adults and 1 child
- **27 Deluxe Sea View Rooms - 38m<sup>2</sup>**  
Accommodates up to 2 adults and 1 child
- **15 Resort View Junior Suites - 64m<sup>2</sup>**  
Accommodates up to 2 adults, 1 child & 1 infant
- **8 One Bedroom Suites - 64m<sup>2</sup>**  
Accommodates up to 2 adults, 1 child & 1 infant  
Premium lounge benefits
- **12 Two Sea View Connecting Rooms - 64m<sup>2</sup>**  
Accommodates up to 2 adults, 2 children & 1 infant
- **4 Premium One Bedroom Suites - 122m<sup>2</sup>**  
Accommodates up to 2 adults & 2 children  
Premium lounge benefits





STAY



## JA LAKE VIEW HOTEL

THE LIFESTYLE HUB OF THE RESORT

### 348 rooms & suites

- **159 Deluxe Rooms – 40m<sup>2</sup>**  
Accommodates up to 2 adults, 1 child & 1 infant
- **71 Resort Course View Rooms – 40m<sup>2</sup>**  
Accommodates up to 2 adults, 1 child & 1 infant
- **57 Premium Resort Course View – 40m<sup>2</sup>**  
Accommodates up to 2 adults, 1 child & 1 infant
- **10 Junior Suites – 70m<sup>2</sup>**  
Accommodates up to 2 adults, 2 children & 1 infant
- **7 Resort Course One Bedroom Suites – 132m<sup>2</sup>**  
Accommodates up to 2 adults, 2 children & 1 infant
- **18 One Bedroom Terrace Suites – 168m<sup>2</sup>**  
Accommodates up to 2 adults, 2 children & 1 infant
- **4 One Bedroom Private Pool Suite – 168m<sup>2</sup>**  
Accommodates up to 2 adults, 2 children & 1 infant
- **2 Two Bedroom Outdoor Jacuzzi Suites – 250m<sup>2</sup>**  
Accommodates up to 4 adults, 2 children & 1 infant
- **20 Two Deluxe Connecting Rooms – 80m<sup>2</sup>**  
Accommodates up to 2 adults, 2 children & 1 infant





EAT



REPUBLIK



EIGHTY ONE (81)

## BRING OUT THE FOODIE IN YOU

### 25 restaurants & bars

**ANCHOR RESTAURANT:** JA Palm Tree Court  
Poolside restaurant serving snacks and refreshments

**ANCHOR POOL BAR:** JA Palm Tree Court  
Swim-up pool bar serving refreshments

**LA FONTANA RESTAURANT:** JA Palm Tree Court  
International buffet restaurant

**LA FONTANA POOL BAR:** JA Palm Tree Court  
Swim-up pool bar serving refreshments

**TAMR POOL & TERRACE:** JA Palm Tree Court  
Al fresco terrace serving seasonal delicacies.  
*Exclusive for Palm Tree Court guests only*

**TAMR BAR:** JA Palm Tree Court  
Chic poolside bar serving snacks and refreshments.  
*Exclusive for Palm Tree Court guests only*





EAT



KINARA



SETTE

# BRING OUT THE FOODIE IN YOU

## 25 restaurants & bars

**WHITE ORCHID RESTAURANT:** JA Palm Tree Court  
Contemporary South-East Asian cuisine

**WHITE ORCHID LOUNGE:** JA Palm Tree Court  
Signature cocktails

**EIGHTY ONE (81):** JA Lake View Hotel  
International buffet restaurant

**KINARA BY VIKAS KHANNA:** JA Lake View Hotel  
Speciality Indian restaurant led by Michelin star chef Vikas Khanna

**LAKESIDE CAFÉ:** JA Lake View Hotel  
Poolside snacks

**LOBBY LOUNGE:** JA Lake View Hotel  
Selection of beverages

**REPUBLIK:** JA Lake View Hotel  
Modern gastro pub





EAT



TAPERIA



VASCO DA GAMA

## BRING OUT THE FOODIE IN YOU

### 25 restaurants & bars

**THE VIBE:** JA Lake View Hotel

Adults only poolside bar

**CAPTAIN'S RESTAURANT & BAR:** JA Beach Hotel

Beachfront Mediterranean cuisine with wood fired pizza

**IBN MAJED:** JA Beach Hotel

International buffet restaurant

**OASIS LODGE:** JA The Resort Golf Course

Refreshments and snacks on the golf course

**PALMITO POOL BAR:** JA Beach Hotel

Swim-up pool bar serving refreshments

**SANDBAR:** JA Beach Hotel

Beach bar with a sandy terrace serving refreshments

**SETTE:** JA Beach Hotel

Signature Italian restaurant with specialty Sardinian and Sicilian influences





EAT



# BRING OUT THE FOODIE IN YOU

## 25 restaurants & bars

### SETTE LOUNGE: JA Beach Hotel

Signature Italian lounge serving pre and post dinner drinks

### SIGNATURE LOUNGE: JA Beach Hotel

Exclusive lounge overlooking Signature Pool serving refreshments and snacks

### SUNSET LOUNGE: JA Beach Hotel

Tea lounge overlooking the beach and gardens

### SMOKIN' GUN: JA Shooting Club

Over-the-top burgers and top-notch shakes

### SPORTS CAFÉ: Club Jumana

European pub grub overlooking JA Marina

### STABLES COFFEE STOP: JA Equestrian Centre

Refreshments and snacks at JA Equestrian Centre

### TAPERIA: JA Beach Hotel

Tapas Restaurant with Traditional Spanish Favourites

### VASCO DA GAMA: JA Beach Hotel

Ideal place for drinks and live entertainment





PLAY



## THERE IS FUN,

- Just Splash splash park and splash pad
- 800 metres of private beach
- 7 temperature-controlled swimming pools with swim-up bars
- 9-hole, par 35, championship standard golf course with floodlit driving range, par 3 course, putting and pitching greens
- The Leadbetter Golf Academy Dubai, the first academy in the Middle East offering a holistic approach to golf instruction
- Horse riding stables with instructors
- 4 floodlit tennis courts, squash court and badminton court
- Beach volleyball facilities
- 9-hole mini-golf course
- JA Shooting Club features international standard indoor and outdoor shooting
- 2 Padel tennis courts
- Aviaries with bird shows
- Calm Spa & Salon offering over 40 rejuvenating treatments and services





PLAY



## AND THERE IS MORE FUN

- Private 100-berth full-service marina
- Speciality shops
- Bio-garden with greenhouses for fresh herbs & vegetables
- Watersports centre providing kayaking, SUP boarding, wakeboarding and wakesurfing
- Zumba classes
- Beach volleyball
- Football tournaments
- Billiard games
- Darts tournaments
- Table tennis

## FOR THE LITTLE ONES

- 3 temperature-controlled children's and toddlers' pools
- Crèche (4 months to 23 months)
- Pirates & Mermaids Kids Club (4 years to 12 years)
- Babysitting service available on request
- Kids cooking classes
- Family movie nights
- Kids disco nights





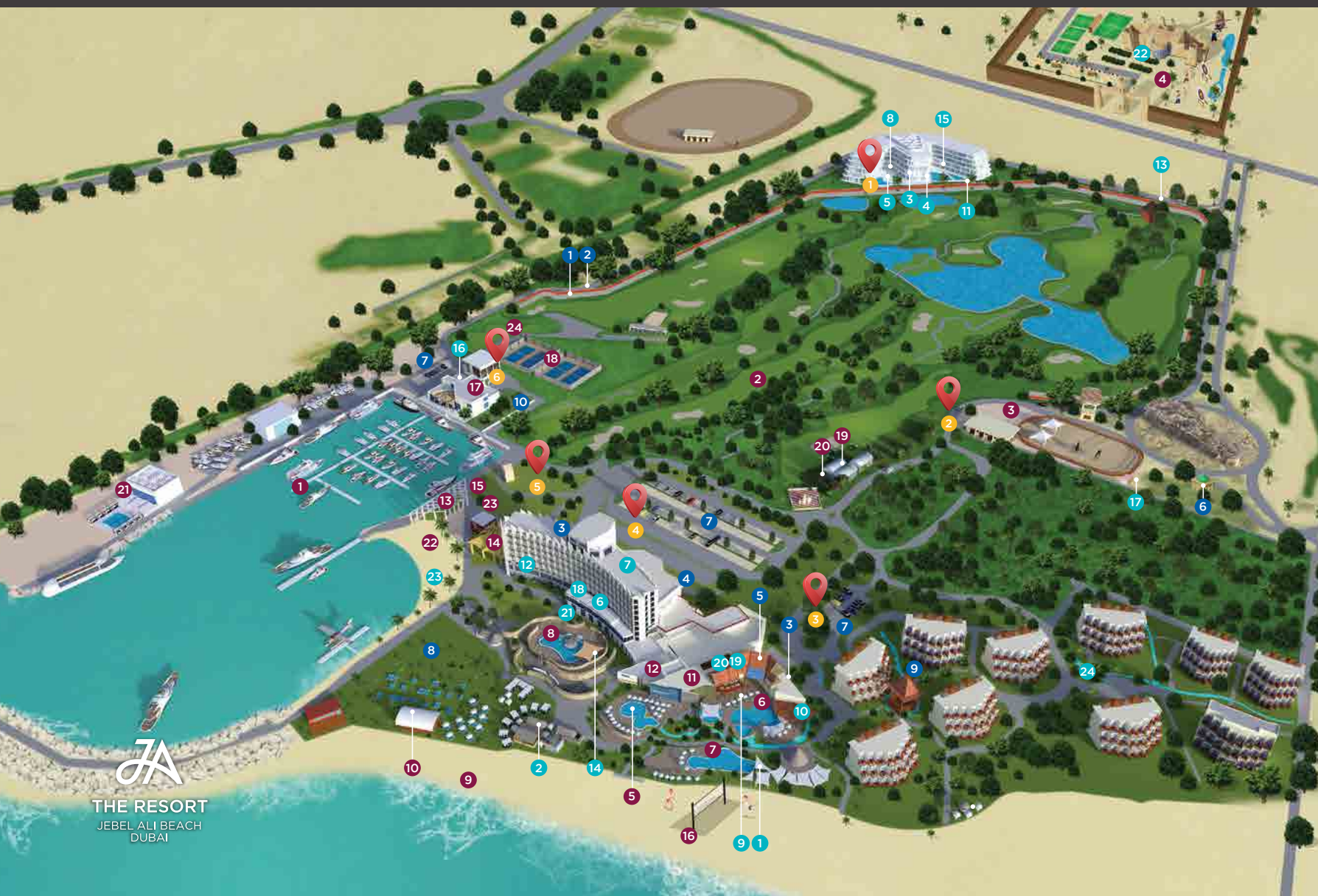

## EXPERIENCES

- 1 JA Marina
- 2 JA The Resort Golf Course & Leadbetter Golf Academy
- 3 JA Equestrian Centre
- 4 JA Sports Centre & Shooting Club (Archery, Football, Cricket, Rugby - 5 min drive from the Resort)
- 5 Signature's Pool
- 6 La Fontana Pool
- 7 Anchor Pool
- 8 Palmito Pool
- 9 Main Beach
- 10 Watercooled Watersports Centre
- 11 Premium Lounge
- 12 Calm Spa & Salon
- 13 Mini golf
- 14 Kids Playground
- 15 Pirates & Mermaids Kids Club
- 16 Beach Volleyball
- 17 Club Jumana (Gym, squash, badminton, table tennis)
- 18 Tennis Courts
- 19 Bio Garden
- 20 Bird Aviaries
- 21 Soulbeach
- 22 Just Splash splash park
- 23 Just Splash splash pad
- 24 Padel tennis

## RESTAURANTS & BARS

- 1 Anchor Pool Bar
- 2 Captain's Restaurant & Bar
- 3 Lobby Lounge at Lake View
- 4 Eighty One (81)
- 5 The Vibe
- 6 Ibn Majed
- 7 Sette
- 8 Kinara by Vikas Khanna
- 9 La Fontana Restaurant
- 10 La Fontana Pool Bar
- 11 Lakeside Café
- 12 Vasco Da Gama
- 13 Oasis Lodge
- 14 Palmito Pool Bar
- 15 Republik
- 16 Sports Café
- 17 Stables Coffee Stop
- 18 Sunset Lounge
- 19 White Orchid Restaurant
- 20 White Orchid Lounge
- 21 Taperia Restaurant
- 22 Smokin' Gun
- 23 Sandbar
- 24 Tamr Pool & Terrace

## BUGGY STOPS

- 1 JA Lake View Hotel
- 2 JA Equestrian Centre
- 3 JA Palm Tree Court
- 4 JA Beach Hotel
- 5 Pirates & Mermaids Kids Club
- 6 Club Jumana

## FACILITIES

- 1 Guest Transportation Path
- 2 Walking Track
- 3 Shopping Arcade
- 4 Conference Centre
- 5 Library
- 6 Mosque
- 7 Car Park
- 8 Palmito Garden
- 9 Amphitheatre
- 10 Croquet Lawn



# THE PURSUIT OF DIFFERENTIATION

## VENUES

- Dividable meeting spaces
- Separate entrance to conference centre
- Advanced audio visual technology
- Spacious outside terrace
- Free Wi-Fi in public areas & all meeting rooms
- Valet parking

### JA BEACH HOTEL

INDOOR VENUES	WIDTH METERS	LENGTH METERS	HEIGHT METERS	SQUARE METRES	THEATRE	U-SHAPE	CLASSROOM	CABARET	BOARDROOM	BANQUET	RECEPTION
Al Saadiyat	10	15	3.5	152	140	24	30	35	24	50	180
Al Habab	10	15	3.5	152	140	24	30	35	24	50	180
Al Hassah	9	14	3.5	128	60	14	20	28	14	40	100
Al Ghubeiba	9	14	3.5	128	80	20	40	35	20	50	100
Hatta Room	7	14	2.5	98	50	18	25	21	20	30	60
Al Saadiyat & Habab	20	15	3.5	300	360	80	150	35	90	160	420
Al Hassah & Ghubeiba	9	28	3.5	252	200	60	90	98	70	120	300
Al Hassah & Ghubeiba & Habab	19	15	3.5	285	380	120	180	161	100	230	475
Al Wasl	28	20	3.5	560	600	100	180	224	100	320	750
OUTDOOR VENUES											
Al Wasl Terrace 1	11	20	-	220	-	-	-	-	-	80	200
Al Wasl Terrace 2	25	15	-	375	-	-	-	-	-	140	300
Croquet Lawn	15	35	-	525	-	-	-	-	-	350	650
Palmito Garden	25	50	-	1250	-	-	-	-	-	800	1500
Amphitheater	9	9	-	81	-	-	-	-	-	-	120
Soul Beach	40	40	-	1600	-	-	-	-	-	1000	1800

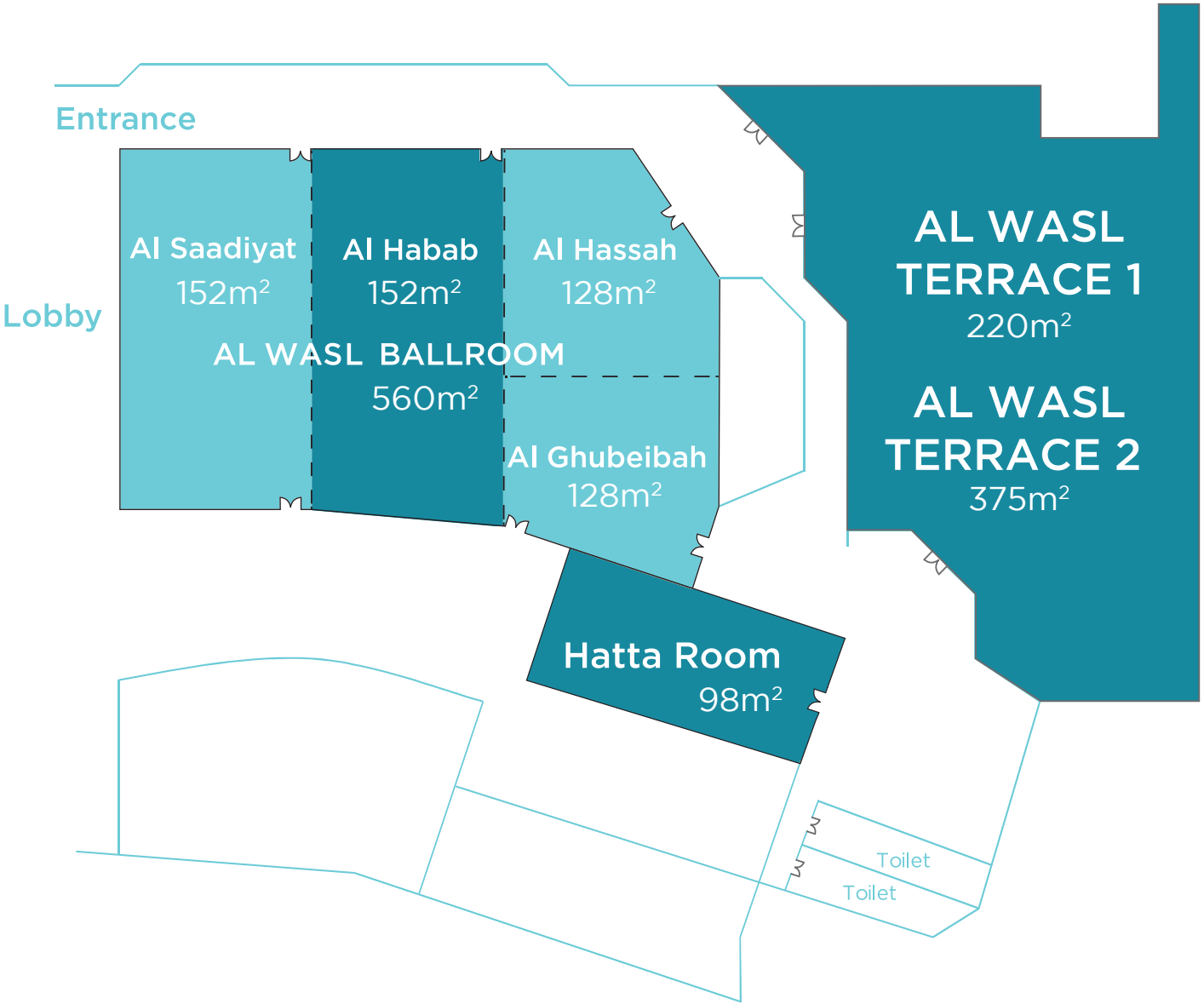



# VENUES

- State of the art meeting rooms
- Natural daylight
- Modern design
- Wi-Fi in public areas and all rooms
- Valet parking available

## JA LAKE VIEW HOTEL

INDOOR VENUES MEETING ROOMS	SQUARE FEET	SQUARE METRES	THEATRE	U-SHAPE	CLASSROOM	CABARET	BOARDROOM	BANQUET	RECEPTION
Air	517	48	48	16	16	-	16	-	50
Sky	517	48	48	16	16	-	16	-	60
Water	517	48	-	-	-	-	16	-	60
Earth	258	24	24	0	12	40	12	-	-
Fire	1195	111	80	30	50	-	30	-	120

## OUTDOOR VENUES EVENT AREAS

Events lawn								80	120
-------------	--	--	--	--	--	--	--	----	-----

### EVENTS AT BIBÉ

Bibé Rooftop Lounge offers a breathtakingly panoramic view of JA The Resort Golf Course, designed by the famous Peter Harradine. This uniquely contemporary and elegant rooftop venue is a great option for intimate VIP functions and socials.

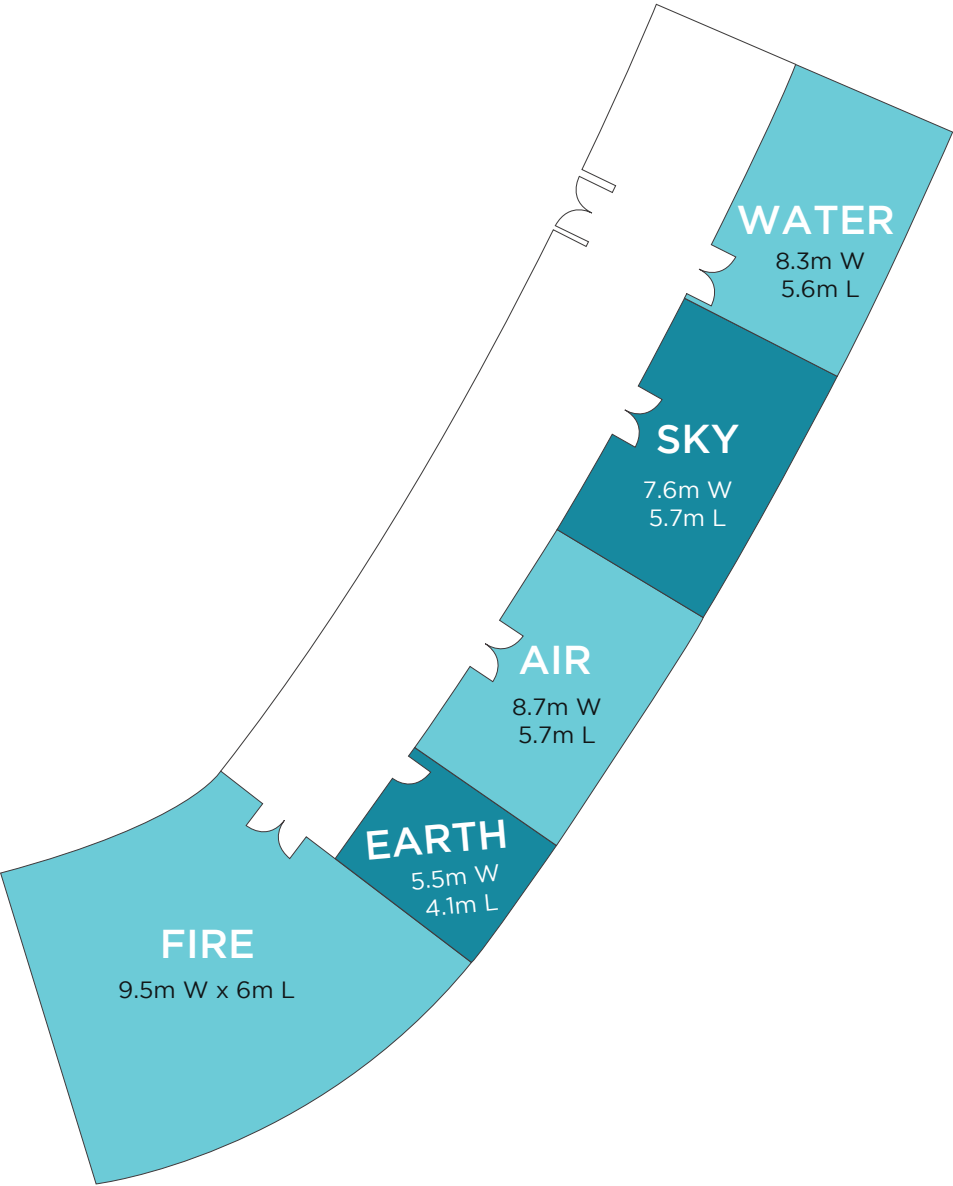



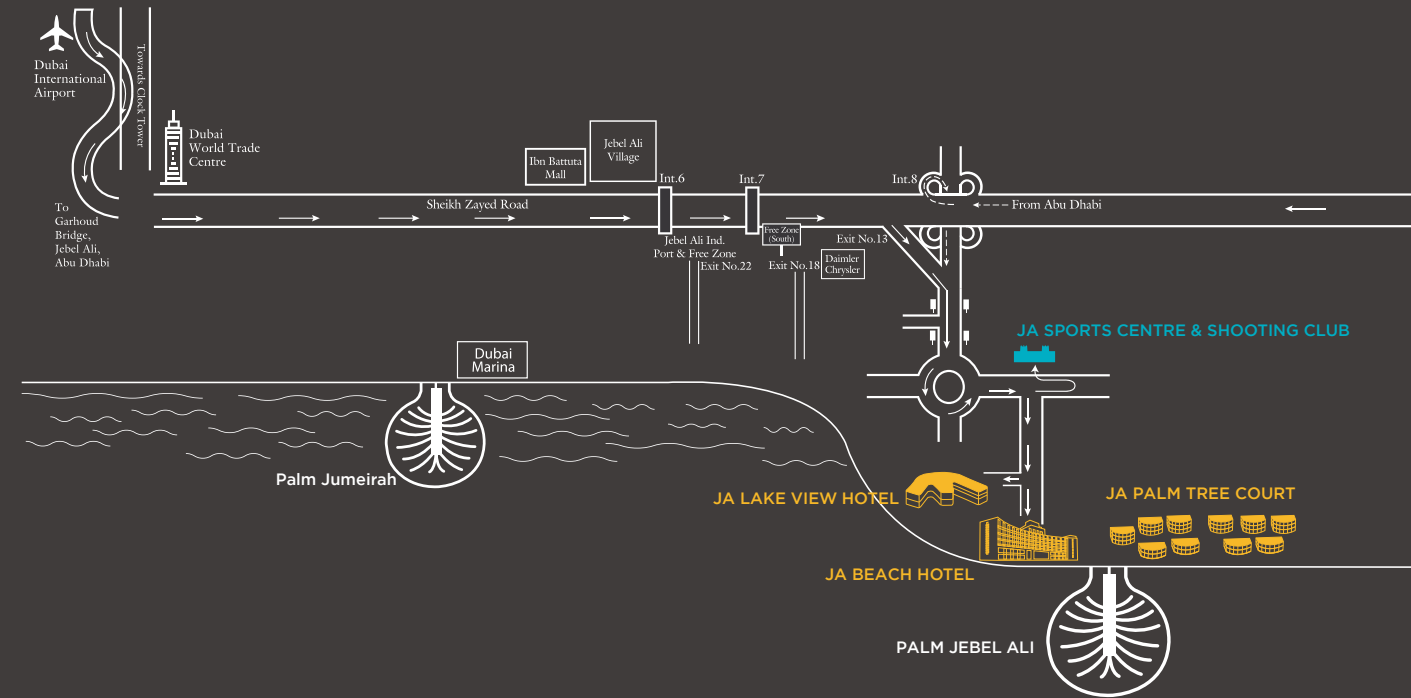

## FROM DUBAI INTERNATIONAL AIRPORT

Follow the Jebel Ali/Abu Dhabi signboards from the airport until you reach Sheikh Zayed Road. Continue straight for approximately 40km, and take Exit No. 13, which will direct you to the Jebel Ali Free Zone (JAFZ) towards gates 7, 8 and 9, and keep right.

Remain on this road and proceed through the traffic light intersection until you approach the initial roundabout, and turn left. JA Sports Centre & Shooting Club will be on your left. Take the exit to the right which has the JA The Resort sign.

For access to JA Lake View Hotel, Club Jumana and JA Beach Club, take the right turn before you reach the hotel's main entrance. For access to JA Beach Hotel and JA Palm Tree Court, continue straight until you reach the roundabout and the resort's entrance will be on the right.

## FROM ABU DHABI

When driving from Abu Dhabi, exit onto Interchange 8 and follow the slip road on the right heading towards the Jebel Ali Free Zone (JAFZA) gates 7 and 8.

Continue on this road and proceed through the traffic light intersection until you approach the initial roundabout, and turn left. JA Sports Centre & Shooting Club will be on your left. Take the exit to the right which has the JA The Resort sign.

For access to JA Lake View Hotel, Club Jumana and JA Beach Club, take the right turn before you reach the hotel's main entrance. For access to JA Beach Hotel and JA Palm Tree Court, continue straight until you reach the roundabout and the resort's entrance will be on the right.





Address: P.O.Box 9255, JA The Resort, Exit 13, Sheikh Zayed Road, Jebel Ali, Dubai, UAE

For more information, get in touch with us on +971 4 814 5555  
or [reservations.jatheresort@jaresorts.com](mailto:reservations.jatheresort@jaresorts.com)

[JAresorts.com](http://JAresorts.com)

[f](#) JAtheresort

[@](#) JAtheresort